

# LOGSPLITTERPLANS.COM

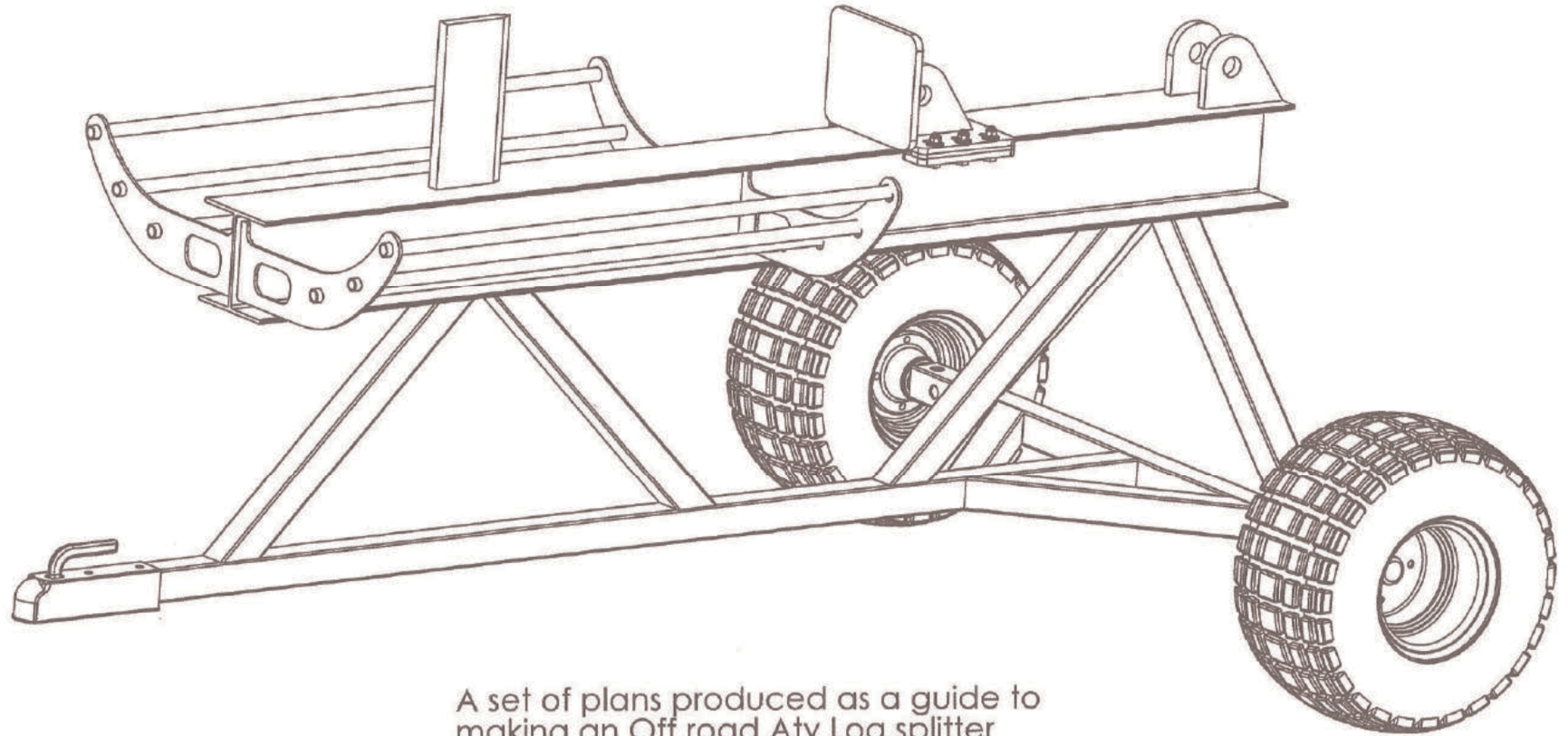

A set of plans produced as a guide to making an Off road Atv Log splitter this kit is based around the log splitting kit supplied by project21designs.com this is a free download, which should only be used as a reference to fitting the kit

## Summary Of an Atv based log splitter.

This is a basic summary of an Atv Log splitter.

this is based around the log splitting kit supplied by [project21designs.com](http://project21designs.com)

the design brief was very simple, build a mobile log splitter with off road capability's and a comfortable working position for long periods.

this design allows for new or used materials i.e Rsj, steel box section, wheels axles etc.

i personally used all new components apart from the hydraulic ram i also made use of a hydraulic power pack, which i use for other equipment, which is why i chose to keep it seperate to the splitter and fitted quick release hoses.

the power pack i used was a Belle unit fitted with a Honda Gx 9hp engine it worked fine, but i would fit a 13hp unit in the future with a two stage pump.

the cutting capacity is approx 19", but this depends on the hydraulic ram & dimensions you choose.

this design puts the wheels at the back of the machine, to give the operator plenty of room to stand and work, it has retaining brackets, so that you don't spend all day picking split logs off the floor

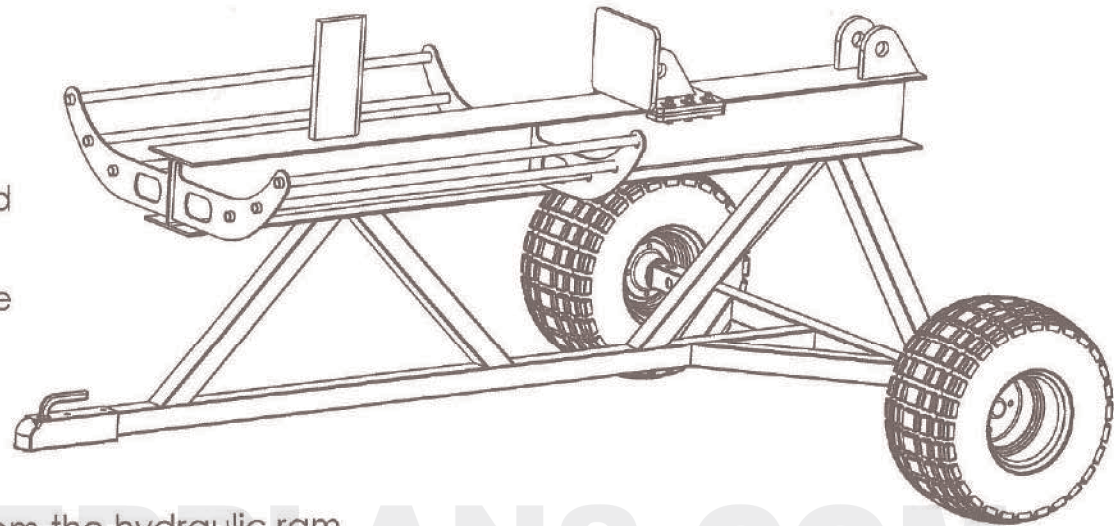

### Disclaimer

These drawings are showing you how i built my log splitting machine.  
These drawings are meant to give some basic guidance & ideas only, anyone choosing to follow these drawings do so at their own risk, any persons using this design should follow any safety regulations in the country they are in.  
this is a basic design only, and does not include any safety features, these are to be installed by the competent persons building the machine, and you should follow any legalisation and safety regulations of the country you are in.  
this design is for an off road splitter only, and should not be used on the public highway.  
by downloading these drawings, you agree to these terms.  
if you don't agree, please don't download them.

# project21designs.com Atv Mobile log splitter

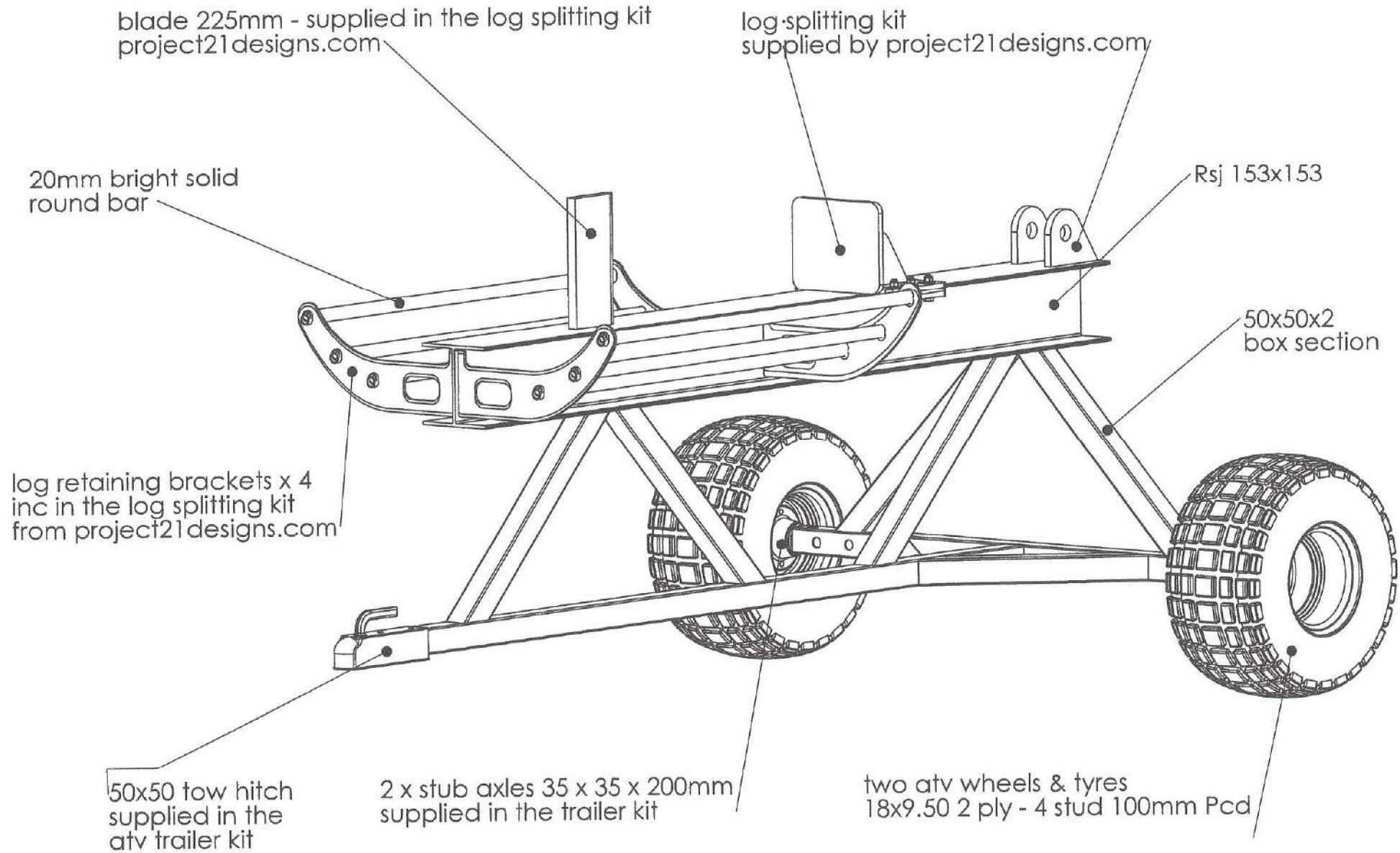

## List of components used

x 2

x2

x1

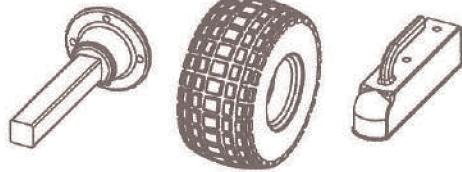

Atv Trailer Kit - supplied off Ebay Uk for £132 inc delivery.  
(december 2013 prices)

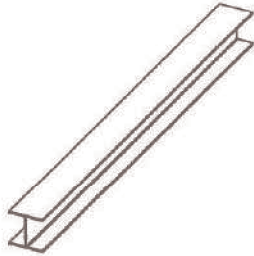

A new 153 x 153 x 23 Rsj -

supplied new £26 per metre  
(December 2013 prices)

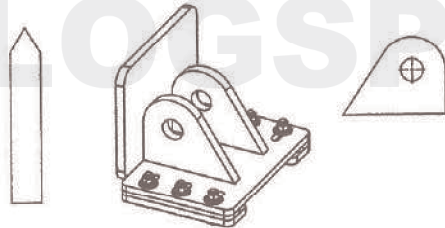

Log splitting kit includes :  
4x log retaining brackets  
1 x blade  
1 x guide rail assembly  
4 x ram brackets

supplied by project21designs.com  
£89 + vat  
(Dec 2013 prices)

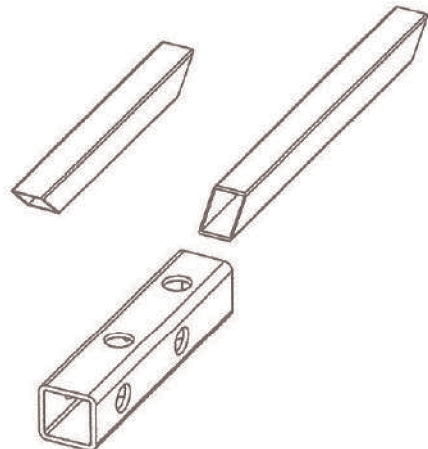

50x50x2 box section mild steel - supplied locally

box section steel - used as a stub axle spacer supplied locally

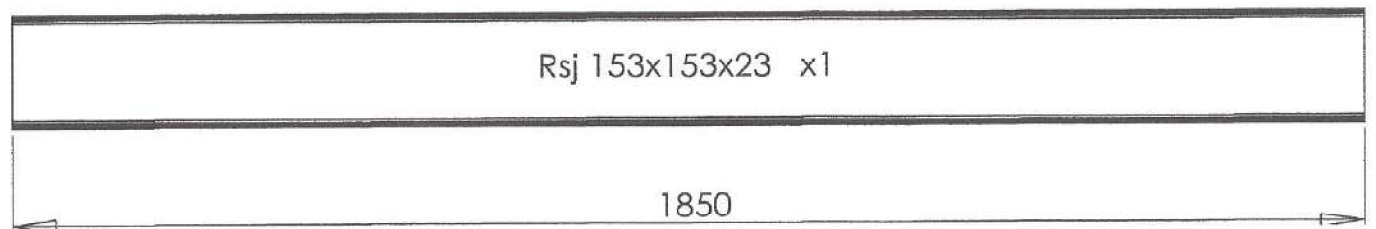
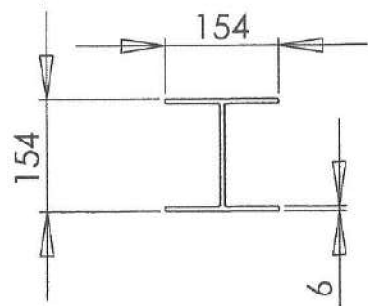
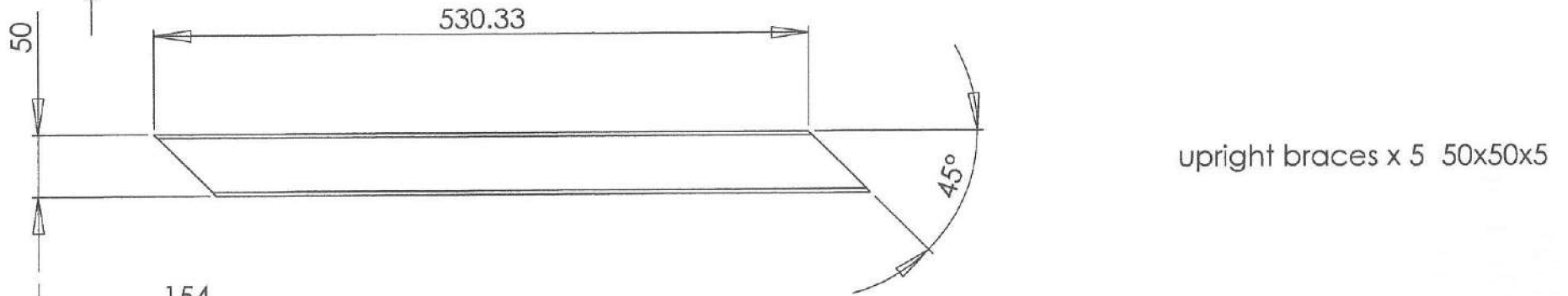
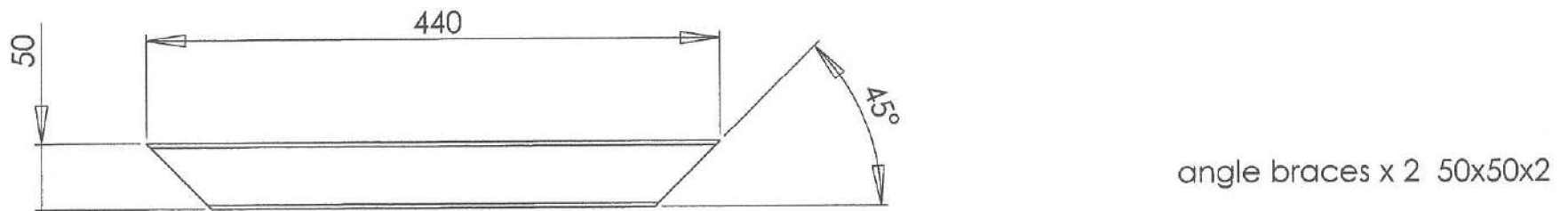
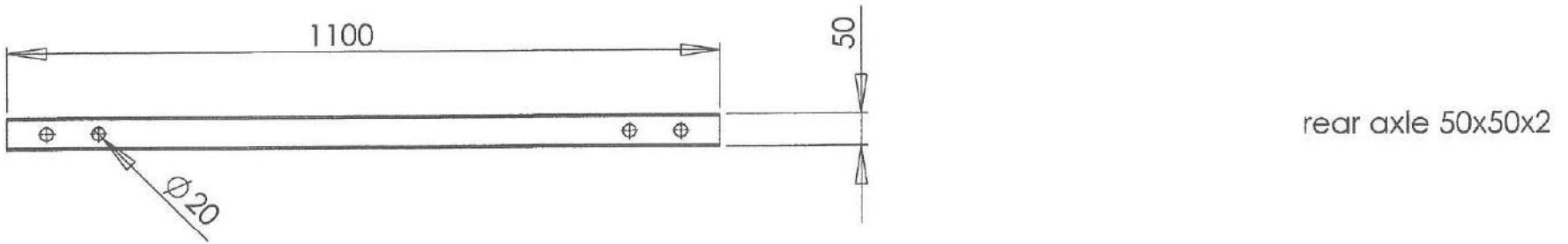
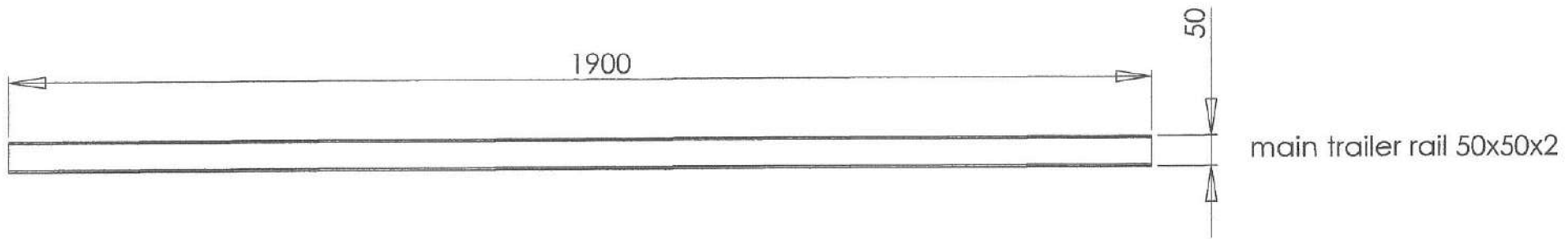

Stub axle spacer

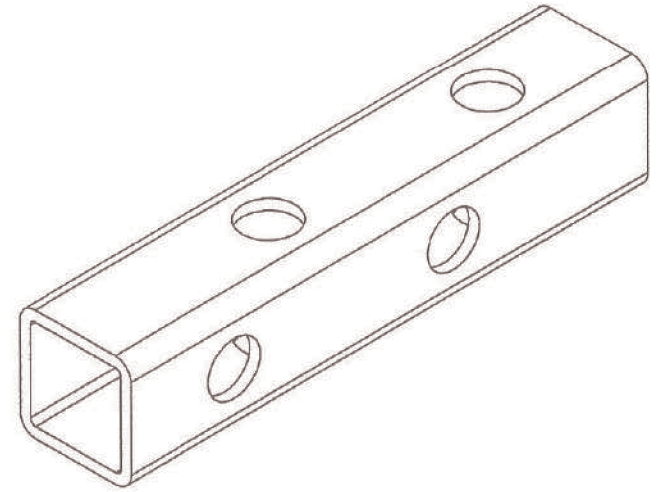
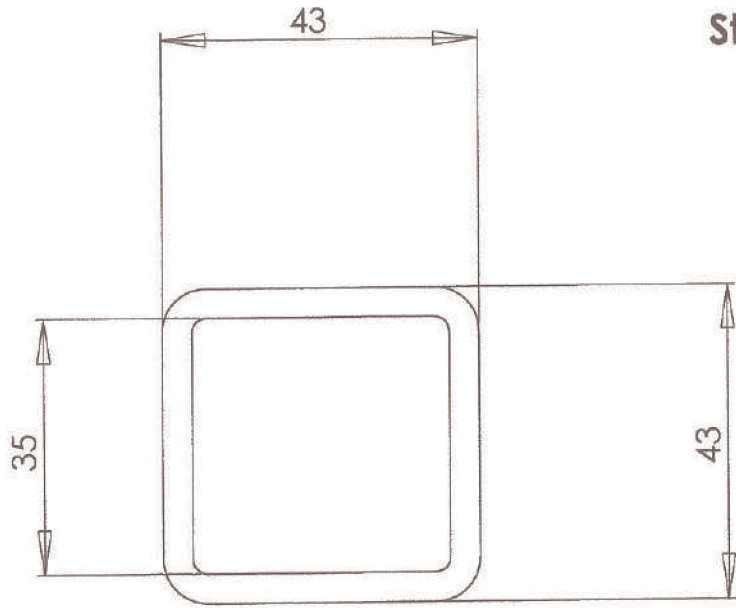

LOGSPLITTERPLANS.COM

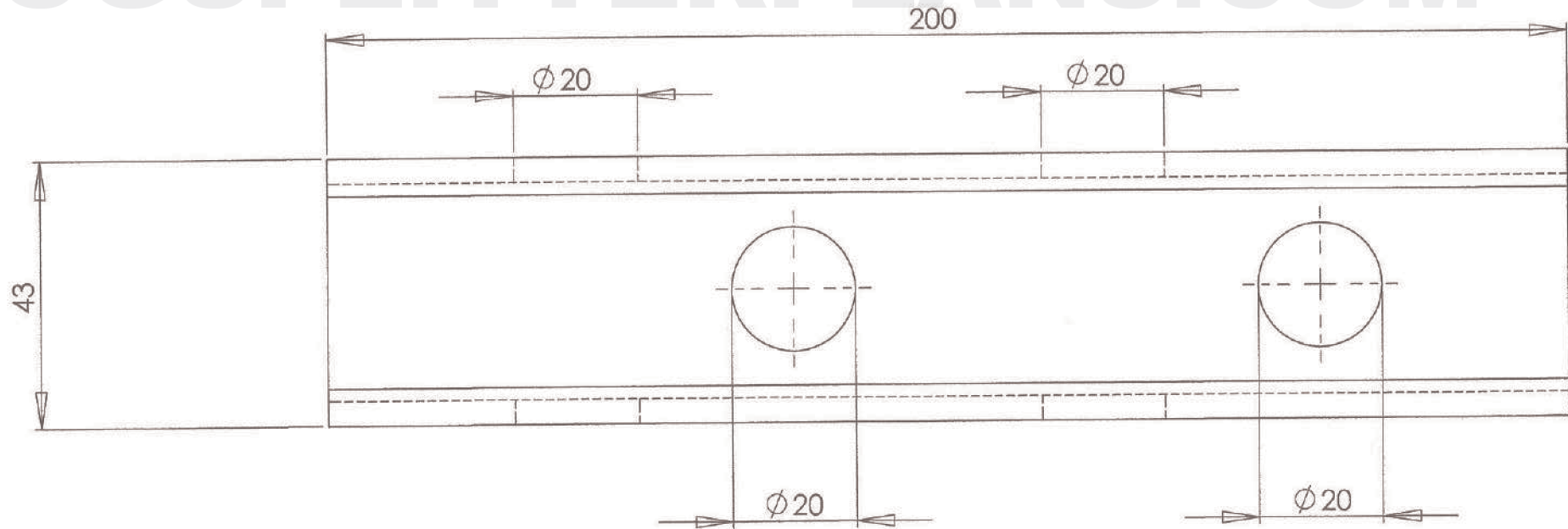

## Stub axle & spacer assembly

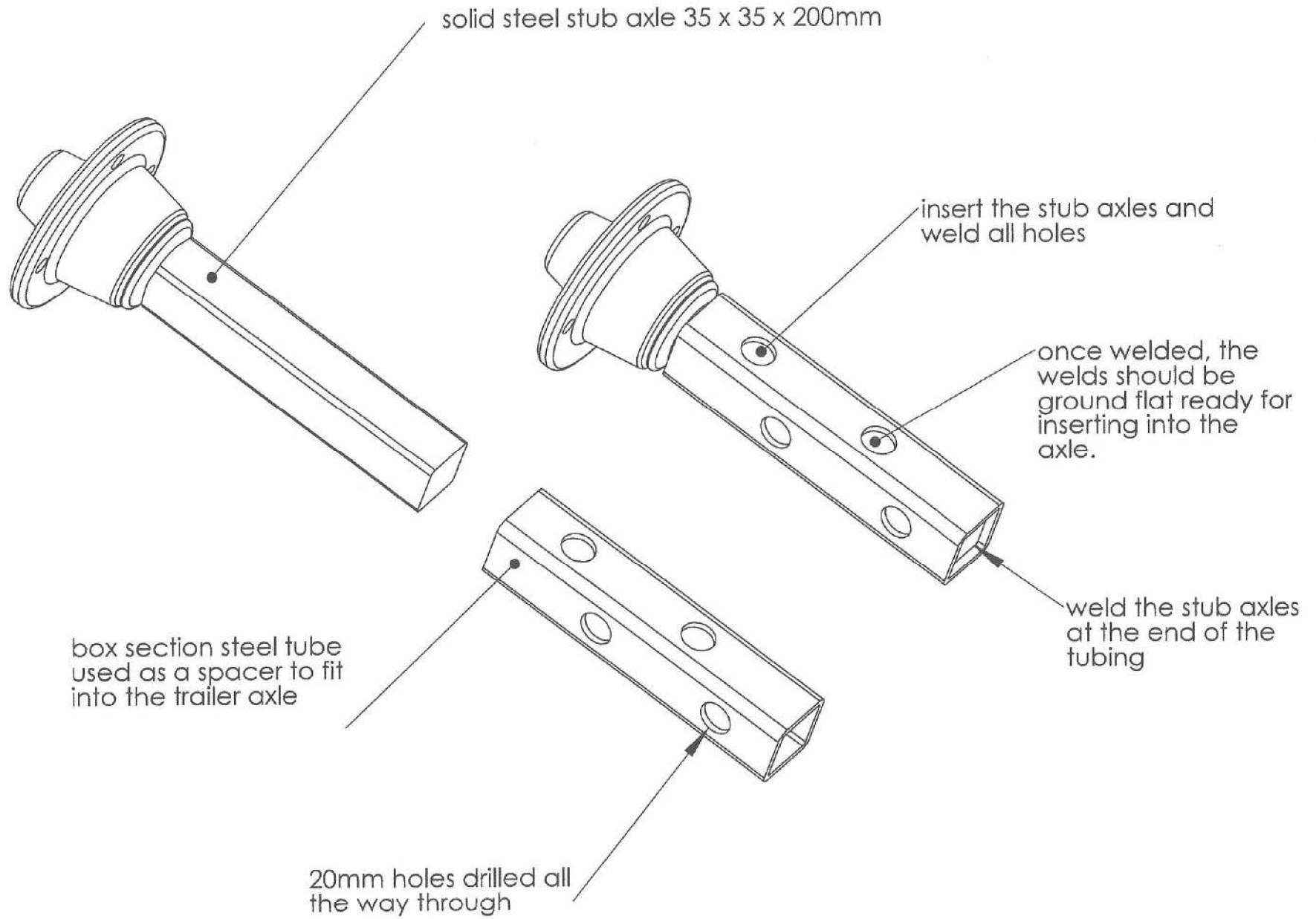

# Trailer Base drawing - project21designs.com

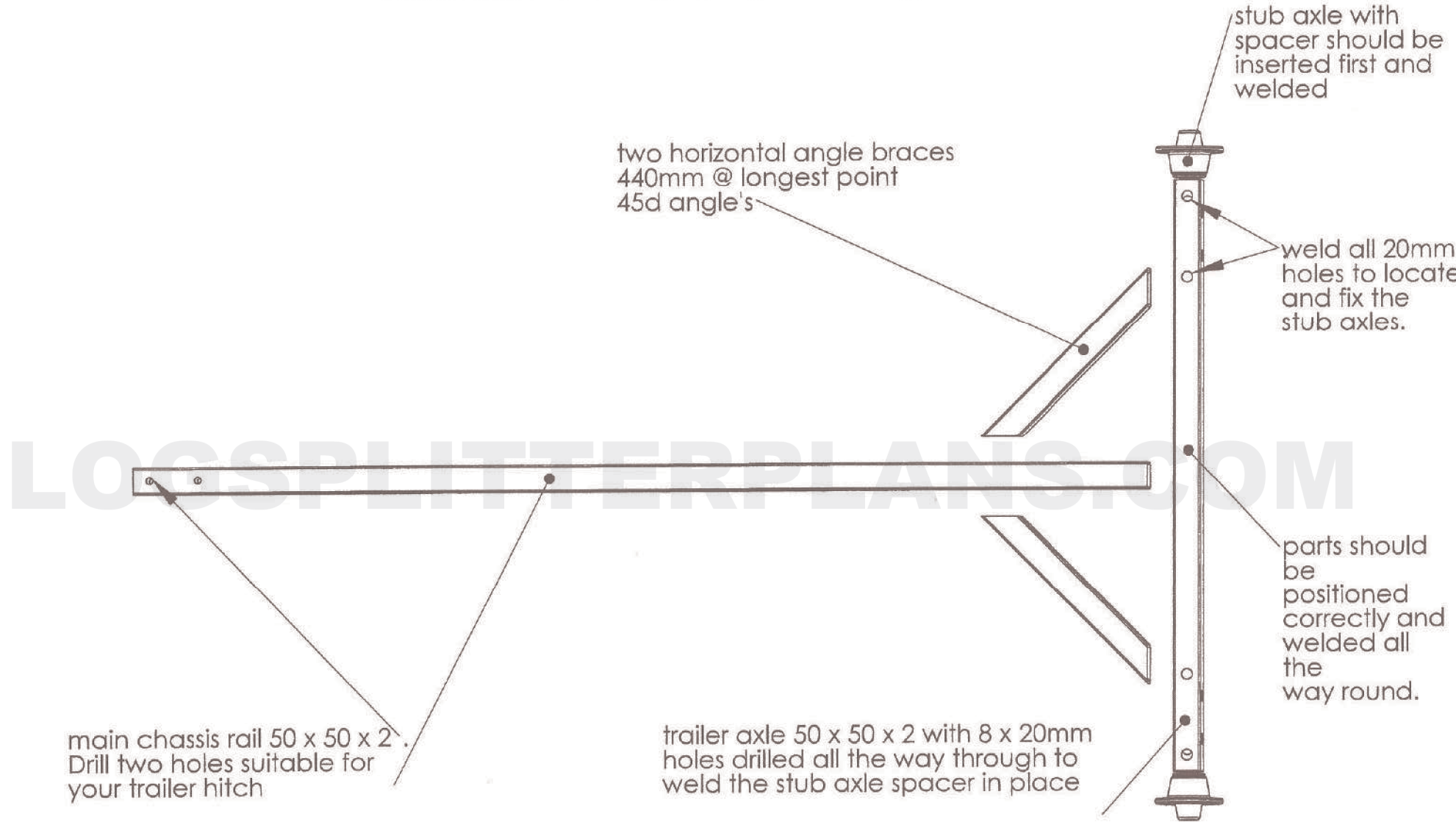



## Mounting the Rsj to the trailer base.

the supports should be placed  
in the centre of the Rsj

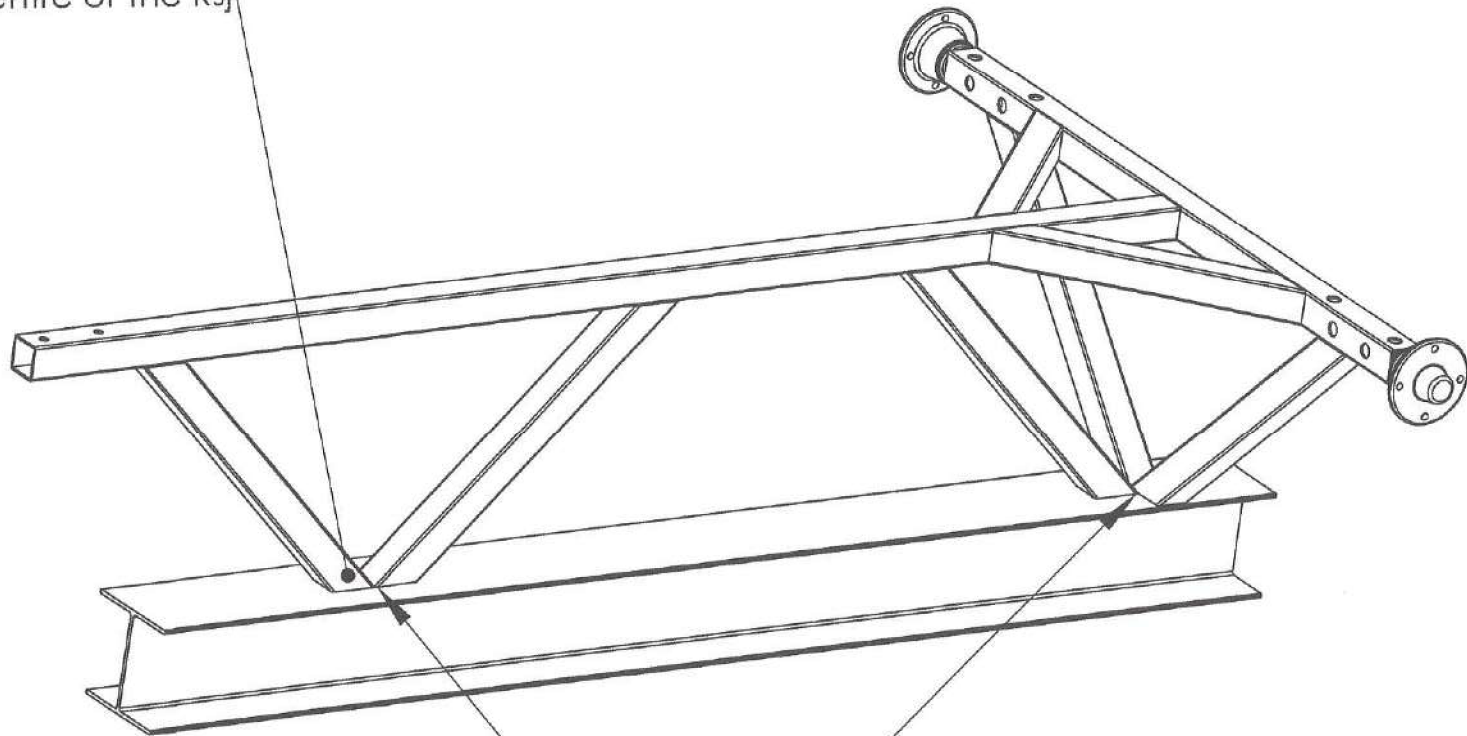

the trailer should be positioned on the Rsj  
and the supports welded all the way around

## Guide Rail Assembly & rear brackets

The guide rail should be assembled first and position the ram brackets to suit your hydraulic ram, then weld all the way around.

the rear brackets should then be positioned to suit the ram and both welded all the way around.

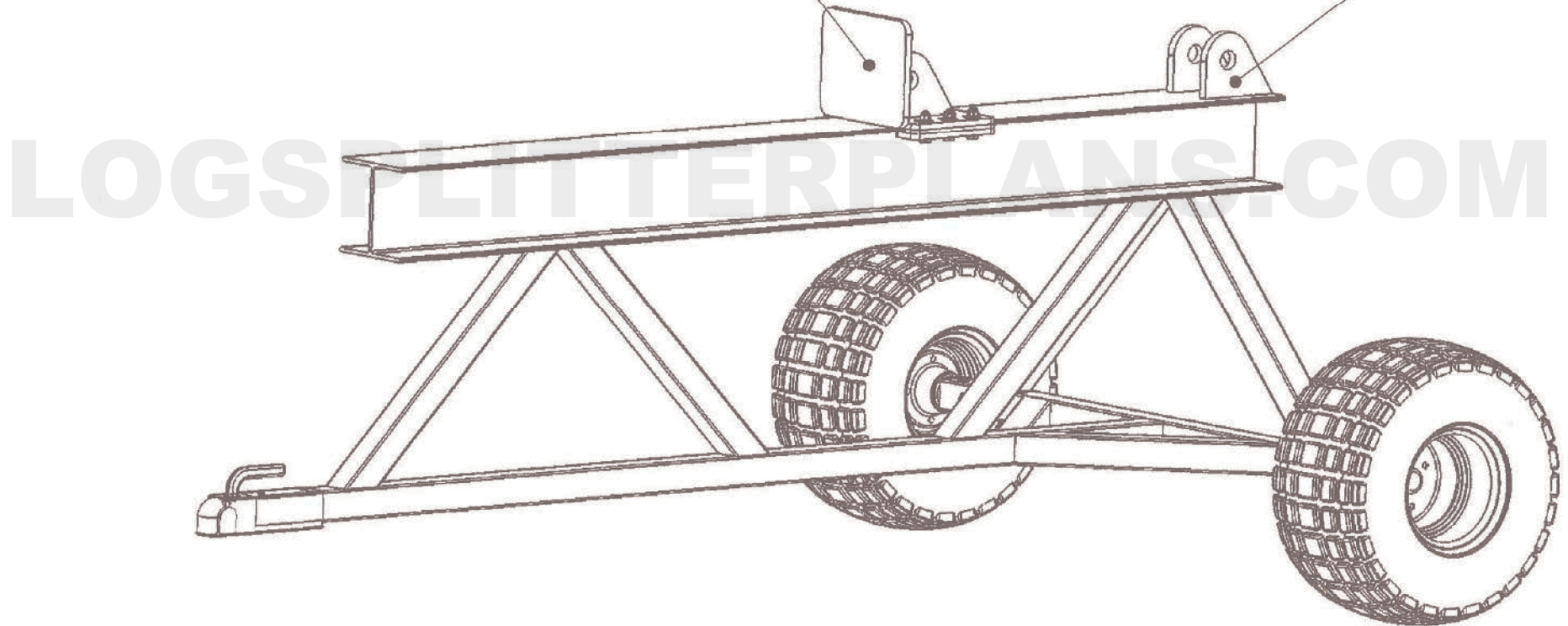

## Blade assembly - project21designs.com

once you have fitted the guide rail and ram brackets in the correct position for your ram, you need to extend the ram out as far as it will go, you then need to leave a 10mm gap between the push plate and the blade this should prevent the push plate hitting and damaging the blade during use.

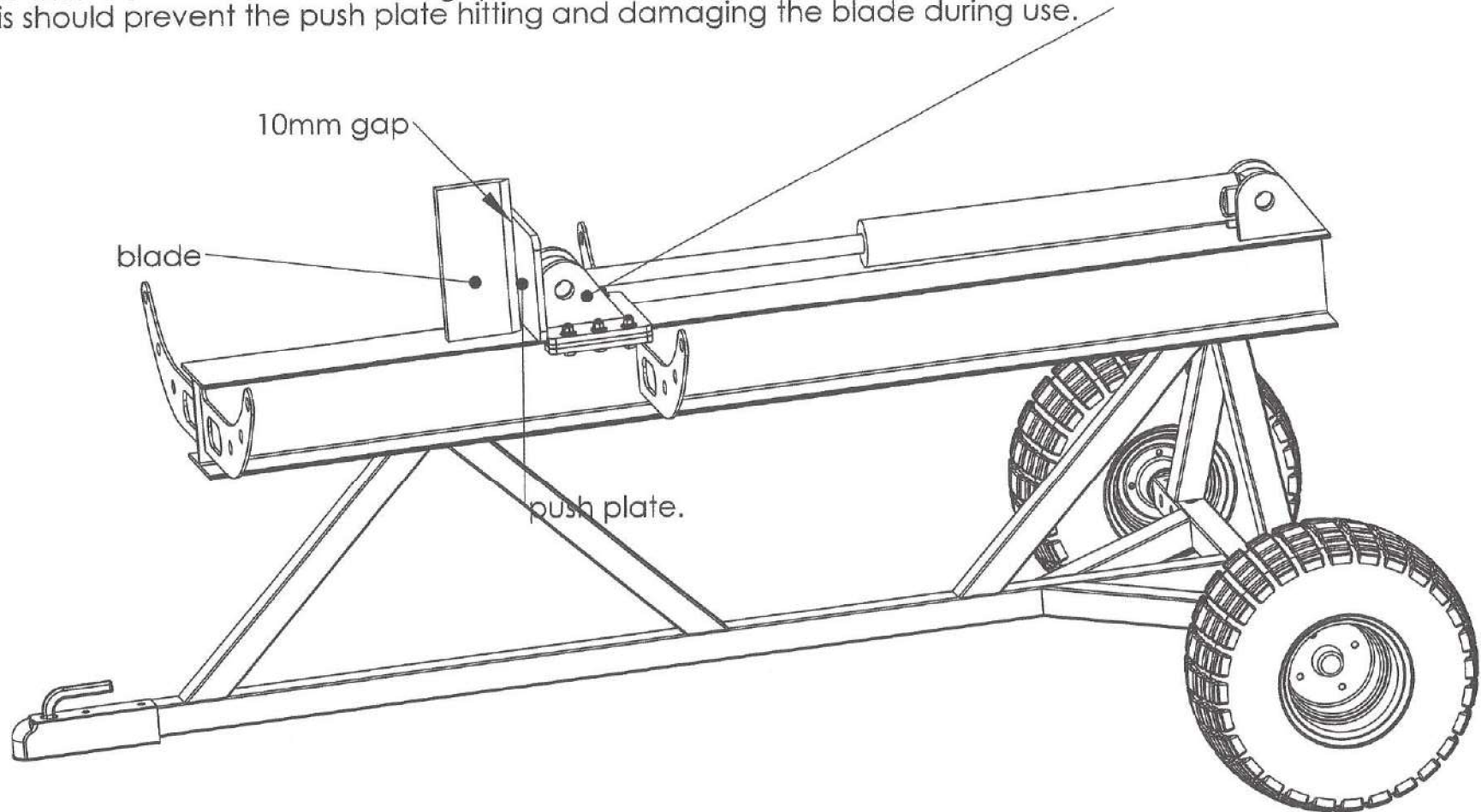

## Log retaining brackets - project21designs.com

when the blade has been welded  
the log retaining brackets should be fitted  
these should be located with the blade approx  
in the middle of the brackets, the brackets should be welded  
onto the rsj, making sure the guide rail clears the brackets  
when it slides front to back.

20mm bright solid steel bars  
should be fitted and welded

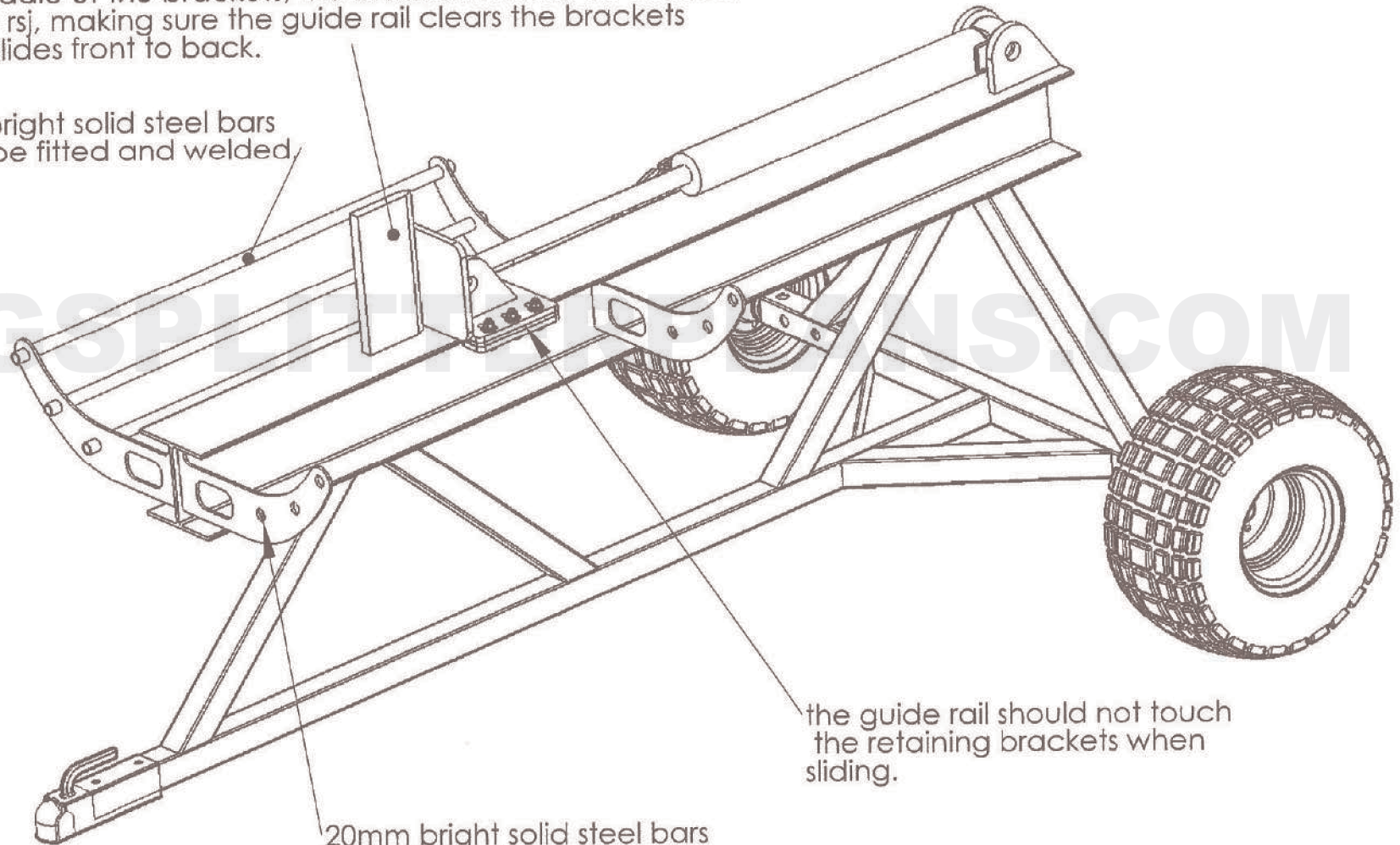

the guide rail should not touch  
the retaining brackets when  
sliding.

20mm bright solid steel bars  
should be fitted in the holes.